

FR-2H 2 Hr Fire Rated Shutter

The UKRS Fire Shutter, tested at Exova Warringtonfire under BS EN 1634-1:2008 test conditions, and assessed to BS EN 476-22:1987, is designed to contain fire within particular parts of a building. In the event of a fire alarm, the shutter automatically descends by operation of the motor. Further failsafe devices to ensure higher levels of response to a fire outbreak or alarm.

Applications

High security commercial and service sites, up to 50m², with 2-hour fire-rating to stop spread of fire through an opening.

Curtain Slat

Single Skin 76mm Curved Steel

Standard galvanised finish.

Wall thickness 0.7mm, 0.9mm, or 1.2mm, depending on overall shutter opening width.

N.B. Colour finishes available on request. Plastisol range or polyester powder-coated.

Visible Surface 76mm

Profile Height 86.6mm

Weight per m² 10kg - 16kg

Maximum Width 12,000mm

Maximum Surface 10m² with single phase power or 50m² with 3-phase power.

Housing

Manufactured from 0.9mm galvanised steel sheet.

End caps are fabricated from 5mm+ steel.

Standard galvanised finish. Other colours available on request. A barrel support frame at the centre of the housing may be required in some applications.

Shutter Height Box Size

Shutter Height (up to mm)	Box Size (mm)
2500	305
4000	355
5500	400

In Line motor applications enclosure projection sizes will vary dependent on the overall shutter size.

N.B. The above enclosure heights are based on standard tube motor operation or In Line external chain drive motor.

Guide Channels / Bottom Slat

Galvanised steel sections with strengthened T-shape bottom bar. Guide channel depth will vary dependent on application from 65mm to 100mm.

Standard galvanised finish. Other colours available on request.

N.B. The guide channels are bolted to fixing angles or steel box sections dependent on the application. See drawings on this sheet.

Operation

Electric: Single phase tubular motor or In Line chain driven motor dependent on curtain weight, with push button control. (In Line motors in either Single Phase or Three Phase supply.

The fire shutter is usually connected to a Fire Control Panel and integrated with the building alarm system, so that the shutter descends under control of the motor in the event of a fire.

Manual override facility is available with the UKRS FS range.

Optional battery backup will supply at least one operation of the door if electricity supply fails.

CE compliant to all relevant European directives and regulations.

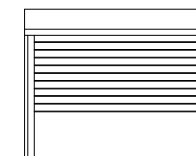
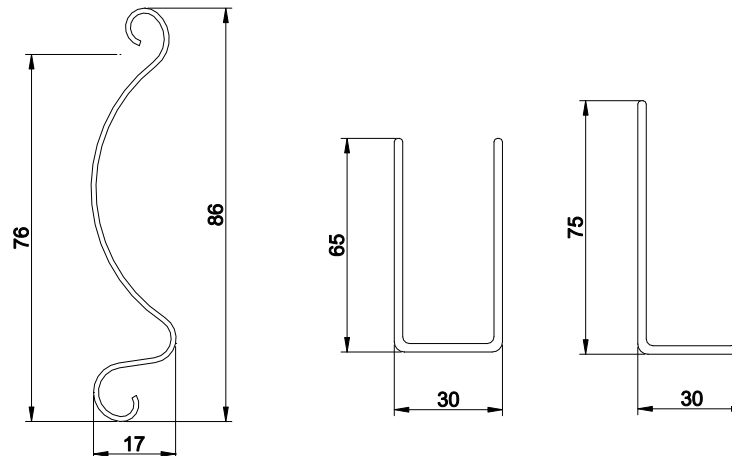
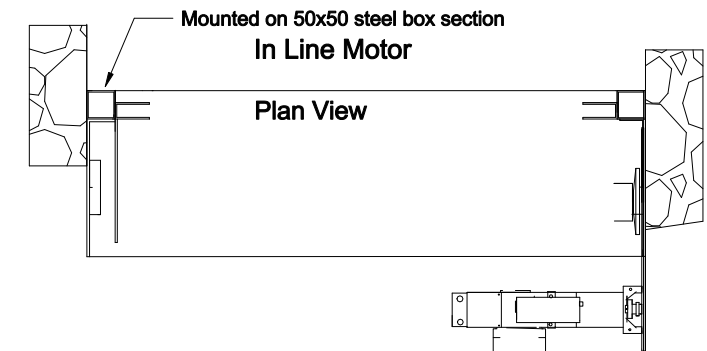
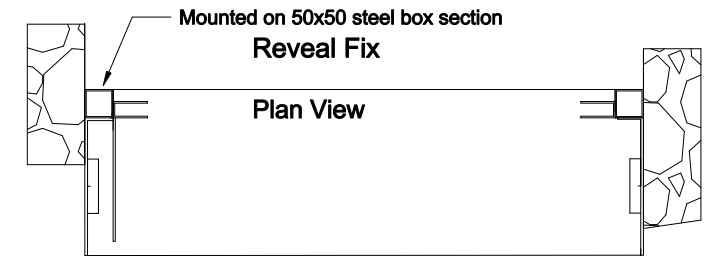
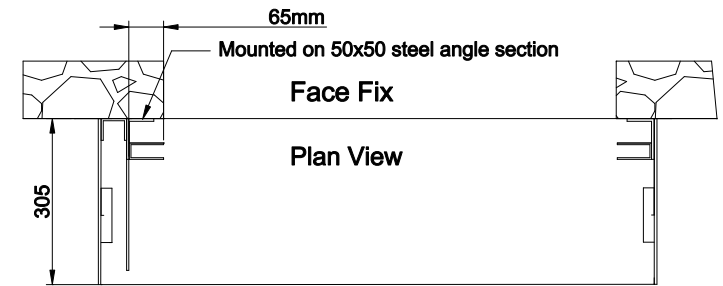
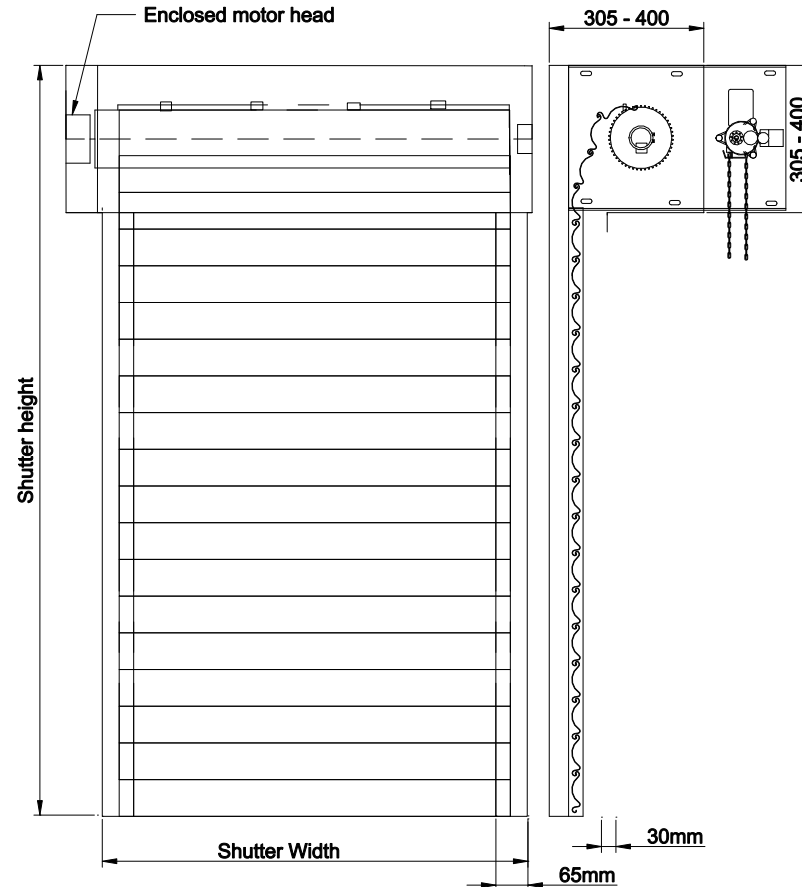

UK Roller Shutters & Garage Doors
Yew Tree Farm
Gospel Ash Road
Bobington
Stourbridge
DY7 5EF

Telephone: 01384 221743